

Product Specifications

Model : WF600-2KZ15

Version No : 20200508

Overview

Model	WF600–2KZ15
Drive	WF600
Pump head	KZ15
Tubing	13# 14# 19# 16# 25# 17#



Dimensions

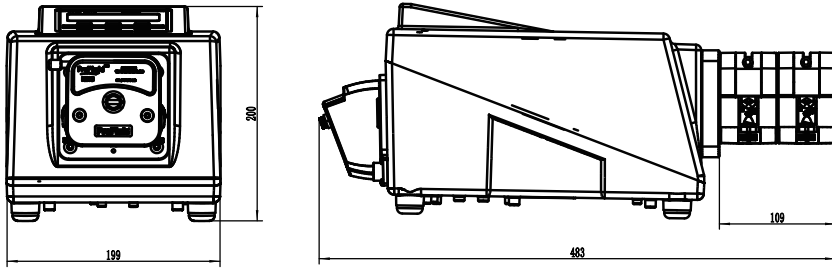

Pump head dimensions

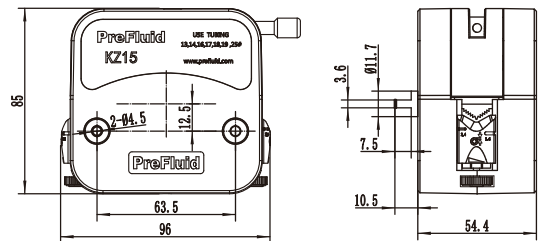

Specifications

Model	WF600–2KZ15
Speed	0.1~600rpm
Speed accuracy rate	0.1rpm
Flow rate	0~1680 ml/min
Speed control	Buttons on console panel
Drive mode	Brushless DC servo drive
Display	LCD screen shows the working modes and parameters
Remote control	DB15 interface
Communication protocol	RS–485, ModBus RTU
Power supply	AC220V/110 (± 10%) 50/60Hz
Power consumption	≤ 50W
Working environment	Temperature 0–40°C, humidity<80%
IP	IP54
Dimension	483mm x 199mm x 200mm
Weight	9.2kg

Rear Panel

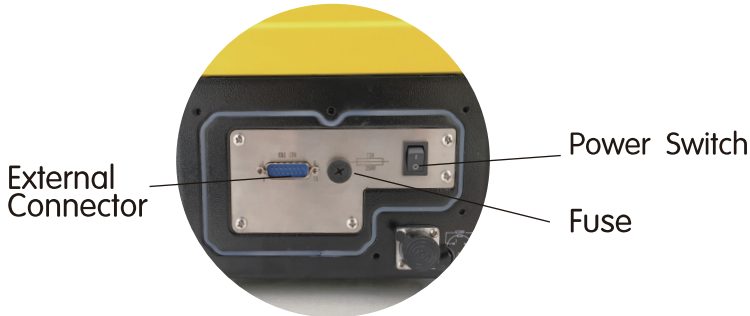

Console Panel

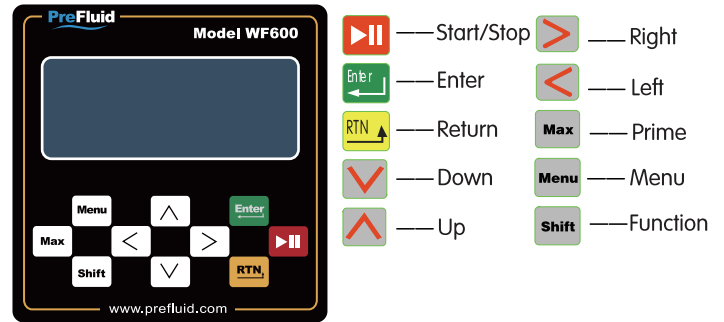

External Control Connector

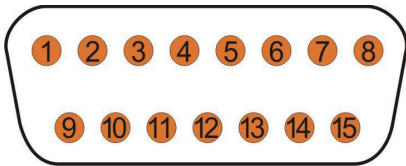

1	+5V, External supply < 100mA	9	A, RS485-A
2	GND, Common ground	10	B, RS485-B
3	F/R, Interface of direction control signal	11	REM, Analog enabled port
4	+12v, External supply < 100mA	12	S/S, Start/Stop control port
5	Iin, Current input (4-20mA)	13	COM, Common port of relay output
6	232R, RS232 Communication receiving end	14	NO, Normal port of relay output
7	232T, RS232 Communication sending end	15	VIN, Voltage input (0-10V), control speed
8	GND, RS232 Communication address		

Connection Between Multiple Pumps

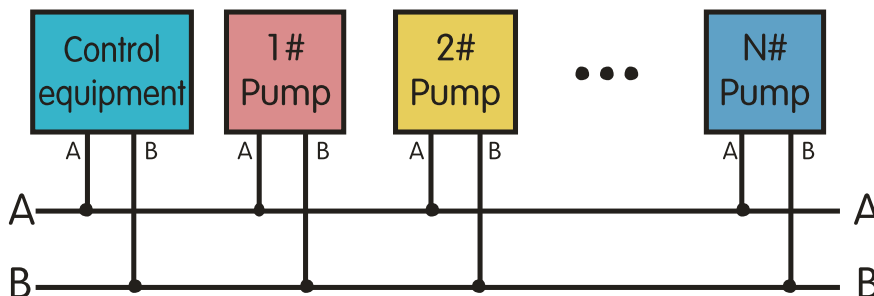

The figure above shows, Use pin 6(A port) and 7(B port) to connect to the external control device
(1 ≤ N ≤ 16)

KZ15 Structure

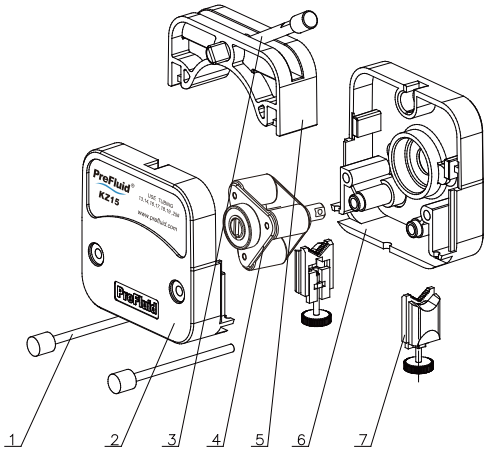

7	Gripper assemblies	1		
6	Back panel	1		
5	Upper compact	1		
4	Roller assemblies	1		
3	Pull rod	1		
2	Front cover	1		
1	Pump head screws	2		
ITEM	PART NAME	QUANTITY	MATERIAL	SPECIFICATION

Flow Rate Curve

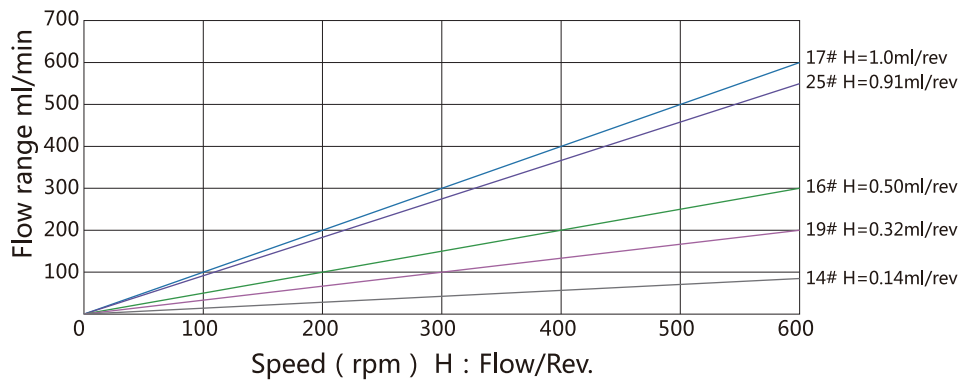

Pulse reduction principle

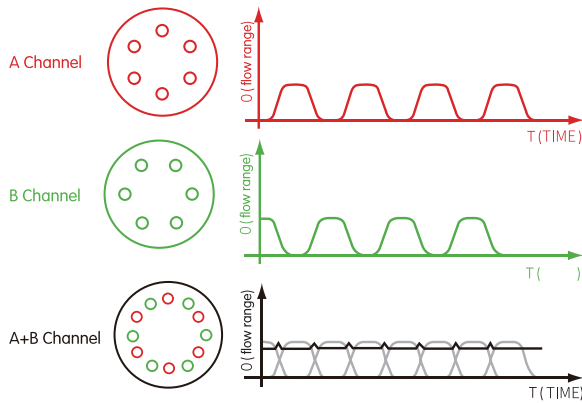

Pump head KZ15(6rollers) running cross with Y Type tubing set ,reduce pulse.

Tube Loading



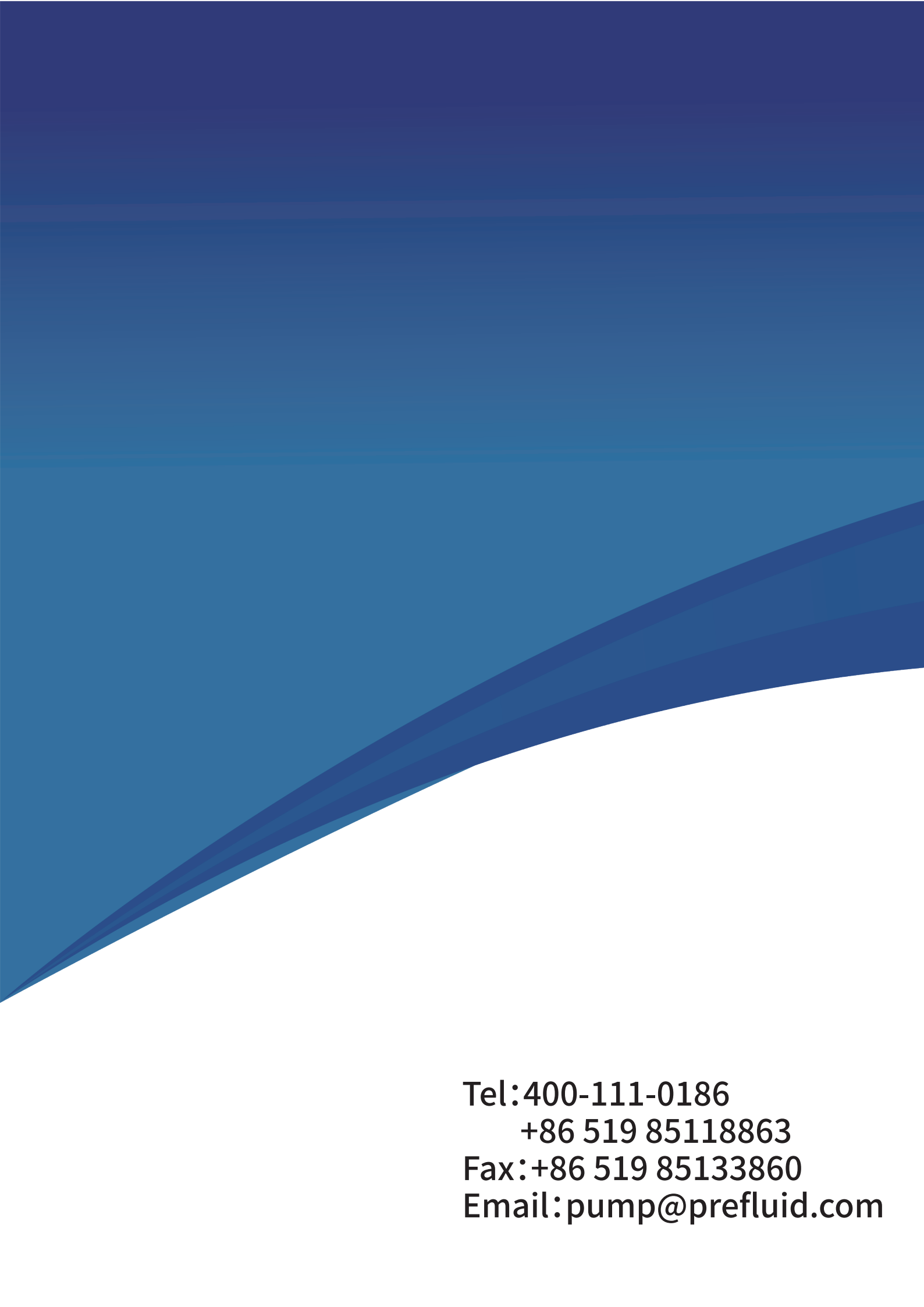

Tel:400-111-0186
+86 519 85118863
Fax:+86 519 85133860
Email:pump@prefluid.com