



SL360–XC45
Product Specifications

Changzhou Prefluid Technology Co.,Ltd.

Overview

Model	SL360–XC45
Drive	SL360
Pump head	XC45
Tubing	88# 90# 92#
Product code	D33600–X450
Flow range	1–33L/min

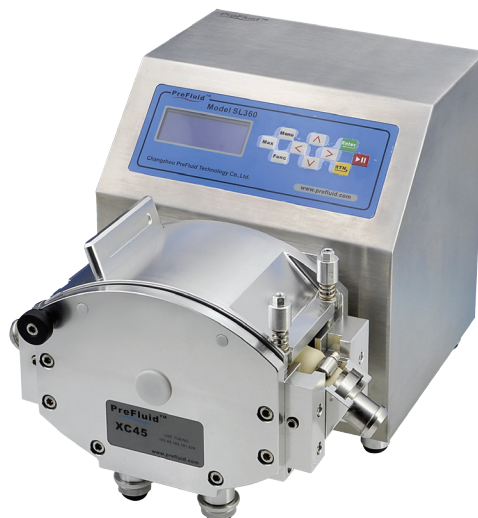

Dimension

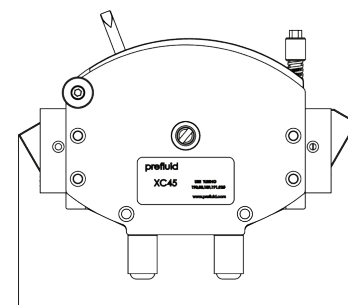
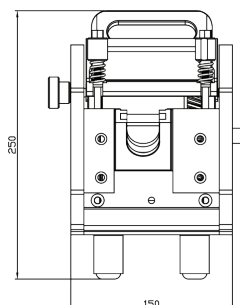
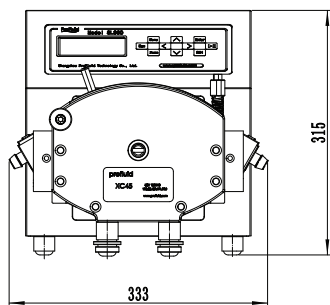
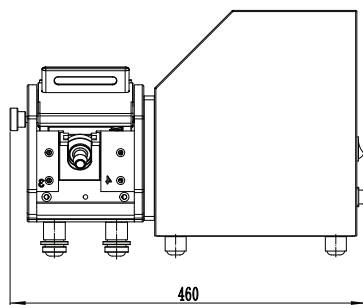

Pump Head

Specifications

Model	SL360–XC45
Speed	10~360rpm
Speed accuracy rate	0.1rpm
Flow rate	1–33L/min
Speed control	Buttons on console panel
Motoe	Large Torque. Quiet Operation. Maintenance Free.
Display	Large LED screen enables clear display of all specifications and English–Chinese menu.
Remote control	Start/stop, direction, speed control.(4–20mA control)
Power supply	AC220V/110V (± 10%) 50/60Hz
Power consumption	≤150W
Working environment	Temperature 0–40°C, humidity<80%
IP	IP54
House	Stainless steel chassis
Dimension	460mm x333mm x 315mm
Weight	31.18 kg

Rear Panel

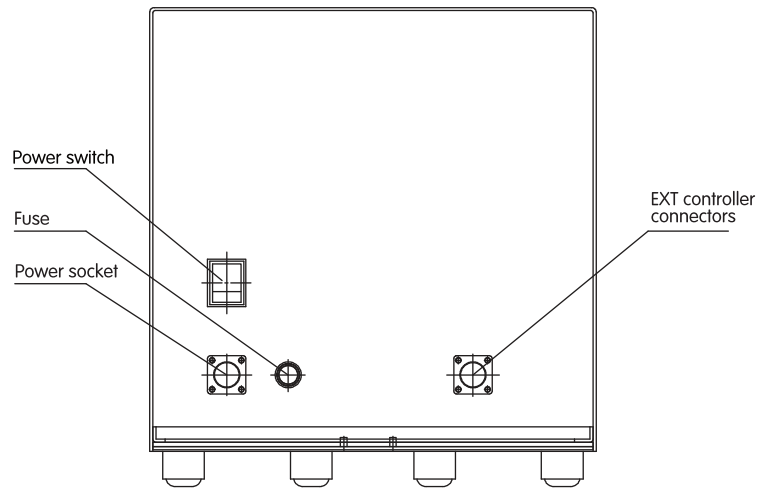

Console Panel

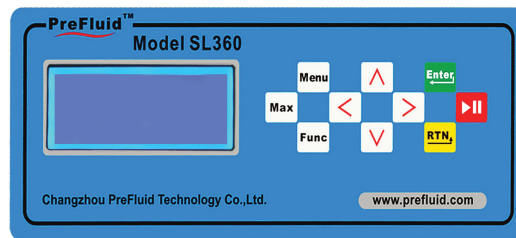

- Start/Stop
- Enter
- Return
- Down
- Up
- Right
- Left
- Prime
- Menu
- Function

External Control Connector

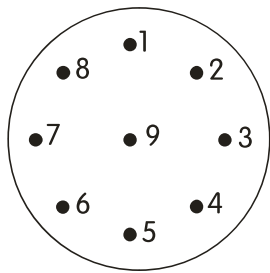

Aviation Plug Socket

External Connector	
PIN	Function
1	+5V, for external control device. Current < 100mA.
2	GND, earth wire.
3	F/R, rotation direction control.
4	+12V, for external control device. Current < 100mA.
5	lin, current (4-20mA) or voltage(0-5V)
6	A, RS485 port A
7	B, RS485 port B
8	Electricity level control signal input
9	Pulse control signal input

Connection Between Multiple Pumps

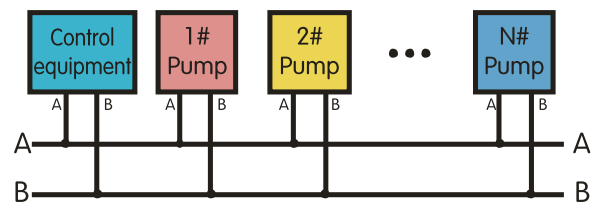

The figure above shows, Use pin 6(A port) and 7(B port) to connect to the external control device (1≤N≤16)

XC45 Structure

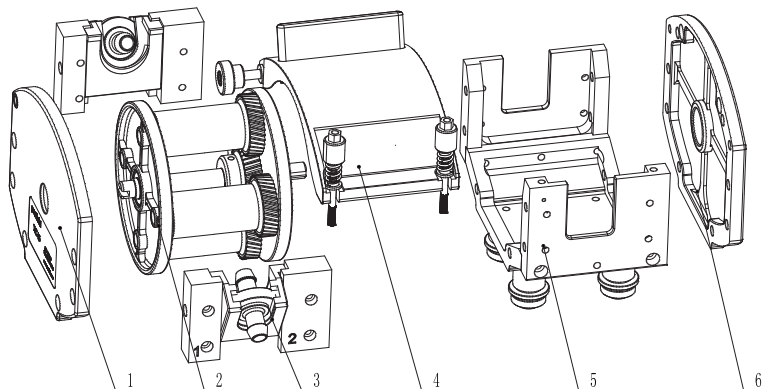

6	Back panel	1	6061
5	Holder assemblies	1	
4	Upper compact	1	6061
3	Gripper assemblies	2	
2	Roller assemblies	1	
1	Front cover	1	6061
ITEM	PART NAME	QUANTITY	MATERIAL

Flow Rate Curve

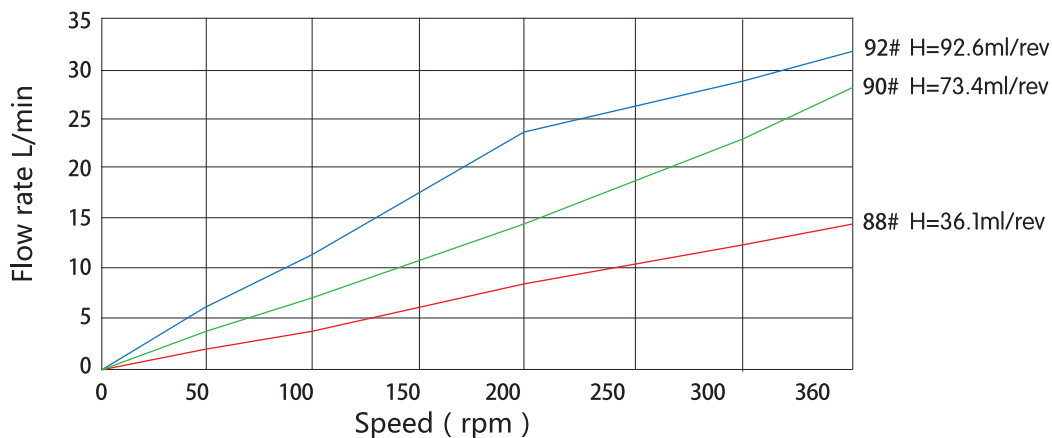

Tube Loading

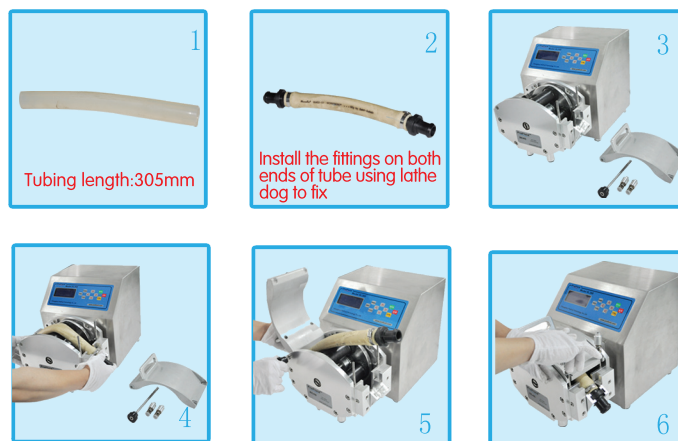

TEL: 400-111-0186 +86 519 85118863
E-mail: Pump@prefluid.com

FAX: +86 519 85133860
ADD: No. 8, Fuqiang Road, Xuejia Town, New North District, Changzhou, Jiangsu, China