



BF200-KZ15
Product Specifications

Changzhou Prefluid Technology Co.,Ltd.

Overview

Model	BF200–KZ15
Drive	BF200
Pump head	KZ15
Tubing	13# 14# 19# 16# 25# 17#
Product code	D22012–K156
Flow range	0.015–1800ml/min



Dimension

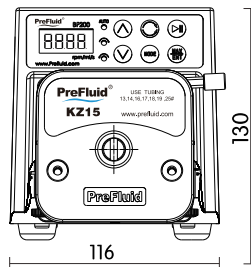
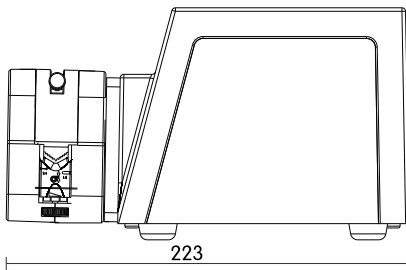

Pump Head

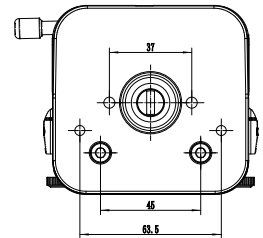
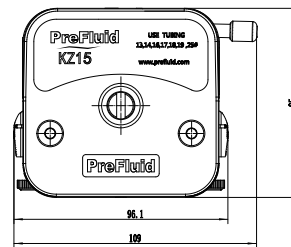

Specifications

Model	BF200–KZ15
Speed	0.1~600rpm
Speed accuracy rate	0.1rpm
Flow rate	0.015–1800ml/min
Speed control	Buttons on console panel
Drive mode	32 subdivision stepping motor
Display	Speed control, rotation direction control, tube size selection simple dispensing
Remote control	Start/stop, direction, speed control.(4–20mA control)
Communication protocol	RS–485, ModBus RTU
Power supply	24V DC
Power consumption	≤30W
Working environment	Temperature 0–40°C, humidity<80%
IP	IP31
House	Die casting Aluminum
Dimension	223mm x 116mm x 130mm
weight	3.2 kg

Rear Panel

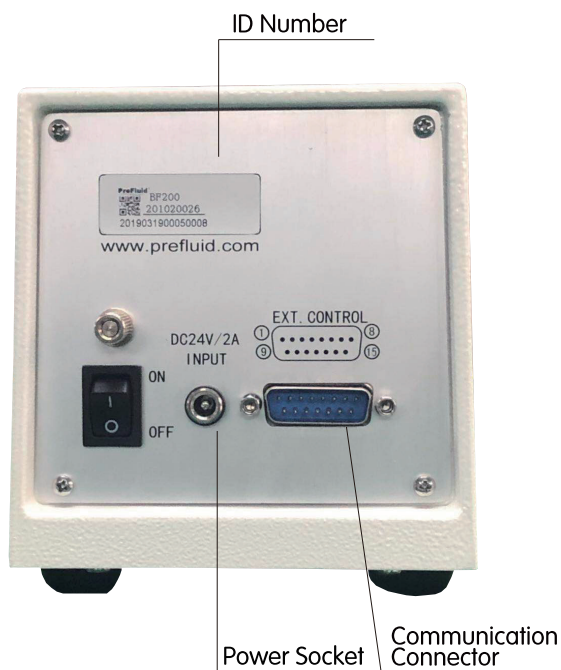

Console Panel



KZ15 Structure

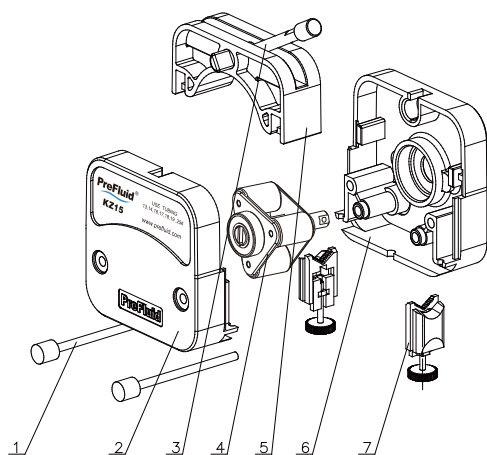

7	Gripper assemblies	1		
6	Back panel	1		
5	Upper compact	1		
4	Roller assemblies	1		
3	Pull rod	1		
2	Front cover	1		
1	Pump head screws	2		
ITEM	PART NAME	QUANTITY	MATERIAL	SPECIFICATION

Flow Rate Curve

KZ15 Three-roller Pump-head

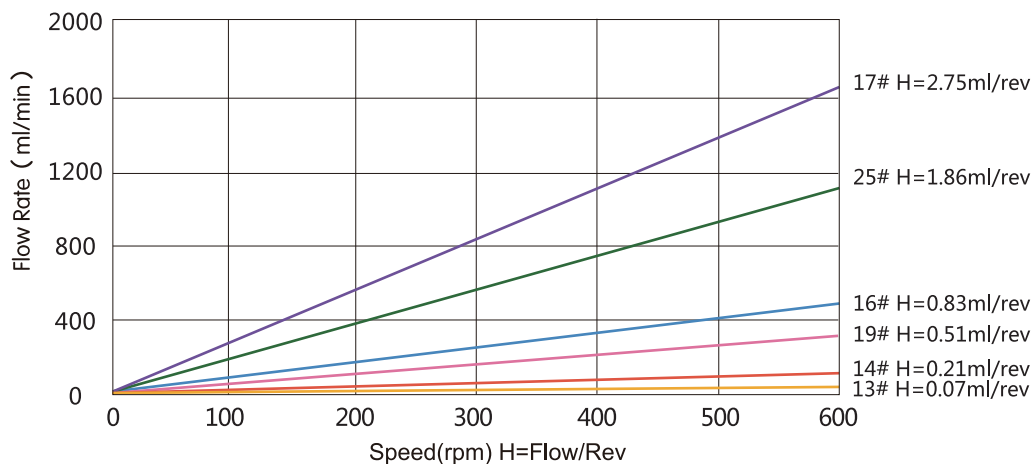

Pressure Performance Curve

KZ15 Three-roller Pump-head

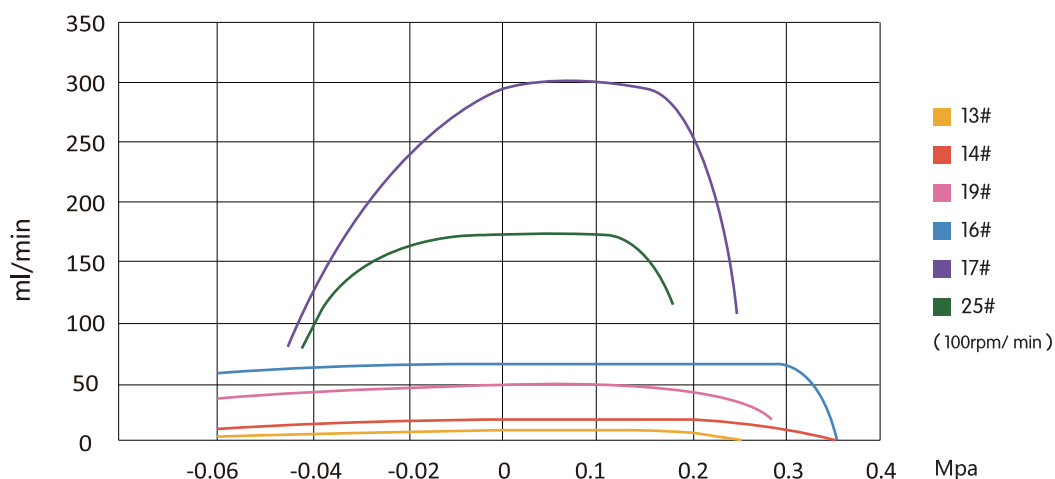

Tube Loading



TEL: 400-111-0186 +86 519 85118863 FAX: +86 519 85133860
 E-mail: Pump@prefluid.com ADD: No. 8, Fuqiang Road, Xuejia Town, New North District, Changzhou, Jiangsu, China